

RoboFocus 2.0 zoom

Electrical system



Total power consumption:	45 W
Power input:	220-240 Vac, 50/60 Hz
Operating temperature:	-10 °C ~ 35 °C
Power factor:	>0.95
Insulation class:	Class II
Motor type:	Stepping motor
Control protocol:	DMX / Casambi / 2,4G Remote control

Motorised 3-phase track lighting. Integrated power supply.

- White
- Black

Features

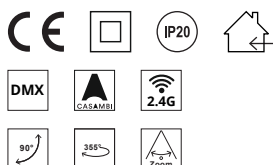

Light source

LED type:	COB
Luminous flux:	3590 lm
Colour temperature (CCT):	2700 K / 3000 K / 4000 K / Tunable White (2700 K- 5700 K)
Colour consistency (SDCM):	≤2
Colour rendering index (CRI):	Ra >90
Beam angle (BA):	12° - 55°

Housing

Material:	Aluminium + Polycarbonat
Weight:	2,55 kg

Warranty

Period:	5 years
---------	---------

Dimensions

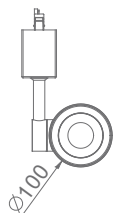
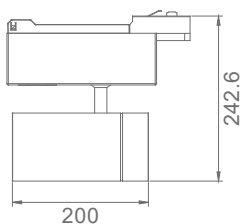

Nomenclature

Type	Series name	System power	CCT	CRI	Beam angle	Control	Colour
TLRF	RoboFocus	45 (45W)	27 (2700K)	90 (90)	Z8 (12°-55°)	X (DMX)	01 (Black)
			30 (3000K)			7 (Casambi)	02 (White)
			40 (4000K)			6 (2.4GHz)	
			TW (2700-5700K)				

*Applicable model: TLR45xx90xxxxx (xx: dynamic codes)

Tolerance: ±2mm

RoboFocus 2.0 zoom

Luminous intensity distribution curves

BA 12°

H (m)	En (lx)	S (sq.m)
1	41526	0,05
2	10381	0,2
3	4614	0,3
4	2595	0,6
5	1661	1,0

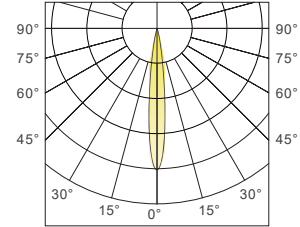

BA 55°

H (m)	En (lx)	S (sq.m)
1	4257	0,8
2	1064	3,3
3	473	7,5
4	266	13,3
5	170	20,8

